

**Mounting instructions for ZWO EAF motor focus on Skywatcher Evolux 62 and 82ED focusers**

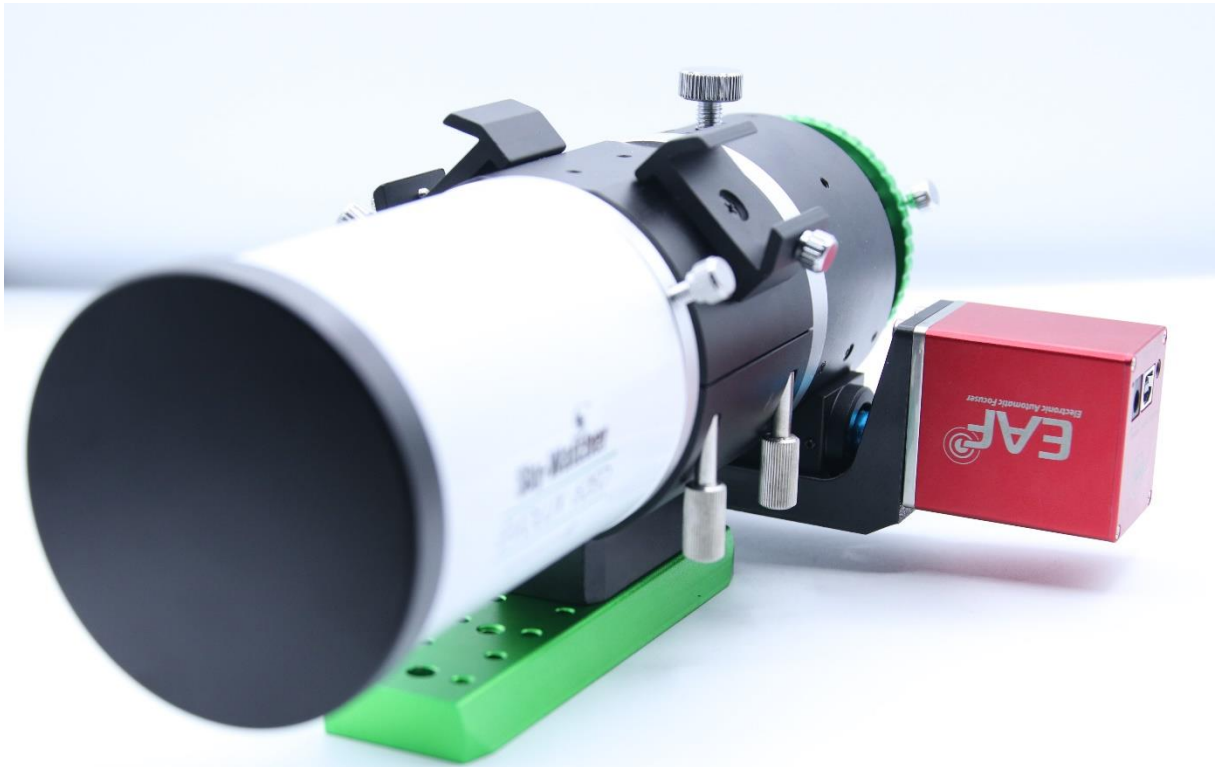

**Scope of delivery:**



- 1) Adapter
- 2) Shaft adapter
- 3) 2x M4x12 Screws

**Mounting accessories are not included in the scope of delivery (Allen key size 4)**

Please always bear this in mind with 3D printed parts! After tight comes off! Tighten the parts carefully so that a firm resistance can be felt. Do not go beyond this.

**To order spare parts, please let us know the color dot on the packaging and the part number shown above. Without this information, we will unfortunately not be able to offer you suitable spare parts for your set.**

**Work step 1:**

On your existing Skywatcher Evolux focuser, loosen the screw on the right side of the focus wheel and then remove it.

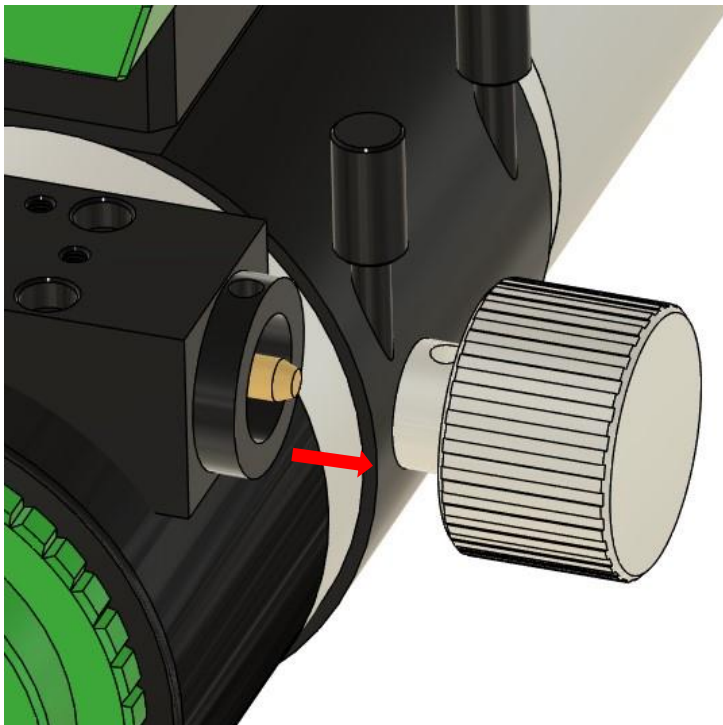
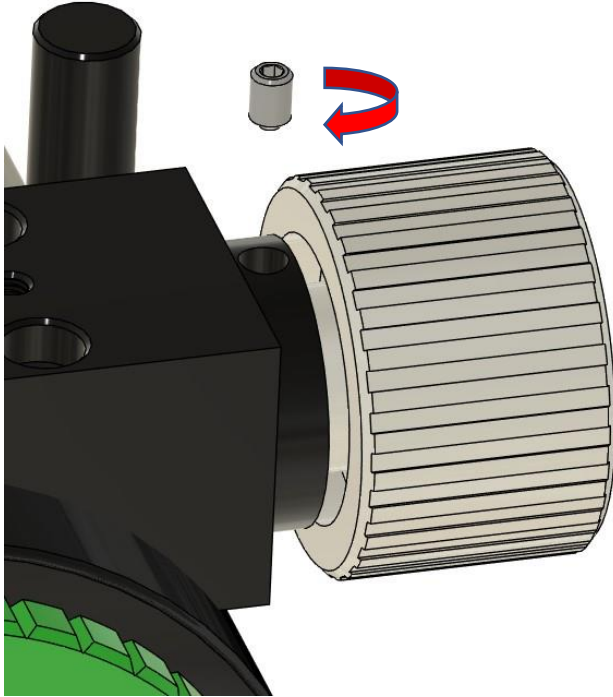

### Work step 2:

Now slide the shaft adapter with the large opening (6 mm) over the exposed shaft of the focuser as far as possible. Ensure that the shaft is in the correct position so that it can be screwed tight on the focuser side.

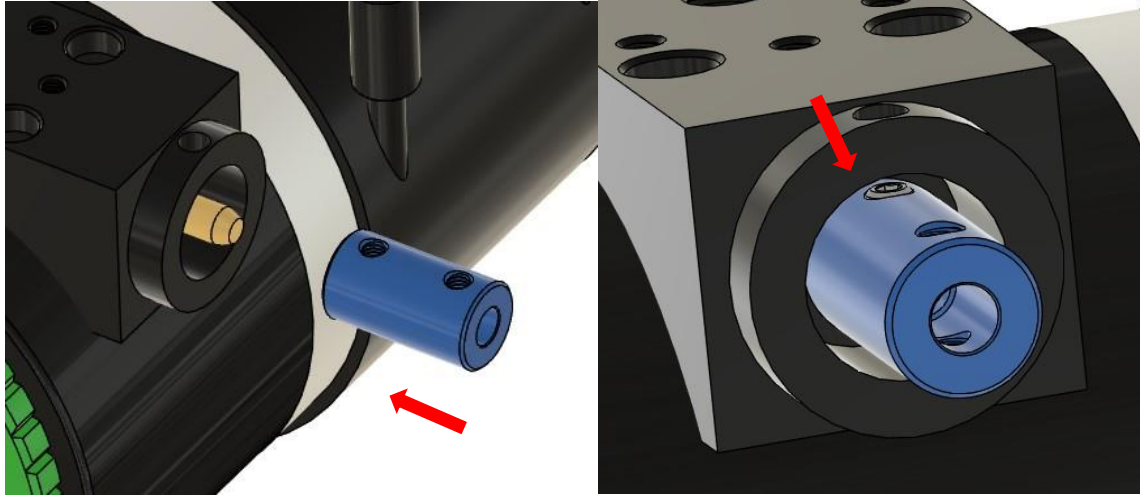

### Work step 3:

Then screw your existing ZWO EAF motor and the adapter (1) together using the two M4x10mm screws supplied with the ZWO EAF.

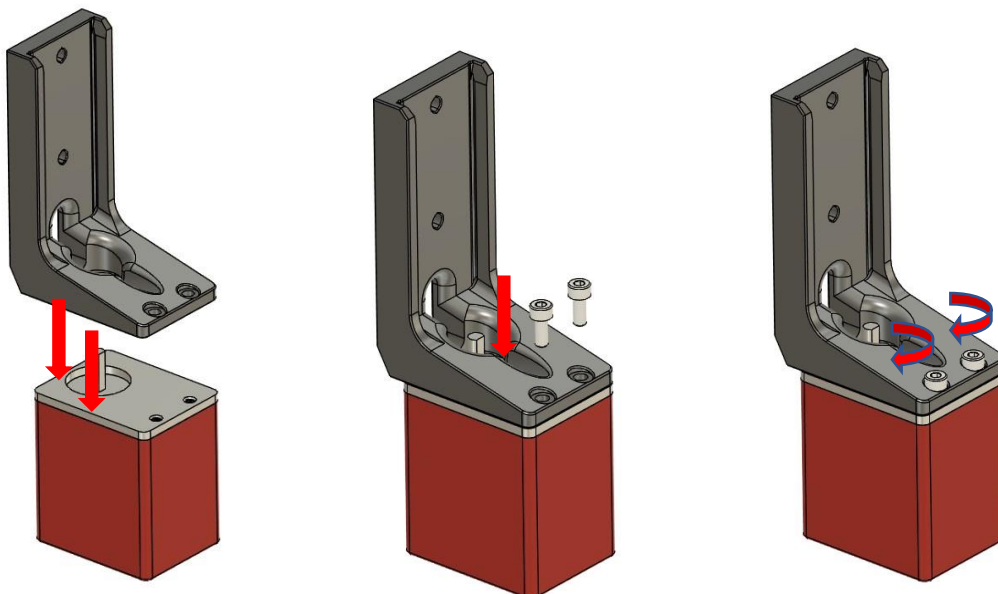

#### Work step 4:

Then slide the adapter (1) with the EAF motor screwed on over the shaft adapter (2) of the Evolux focuser. **Make sure that the screws on the shaft adapter on the EAF side are fully open, otherwise the shaft of the EAF motor cannot be pushed in far enough and the distances for fixing the adapter to the pull-out may not fit!**

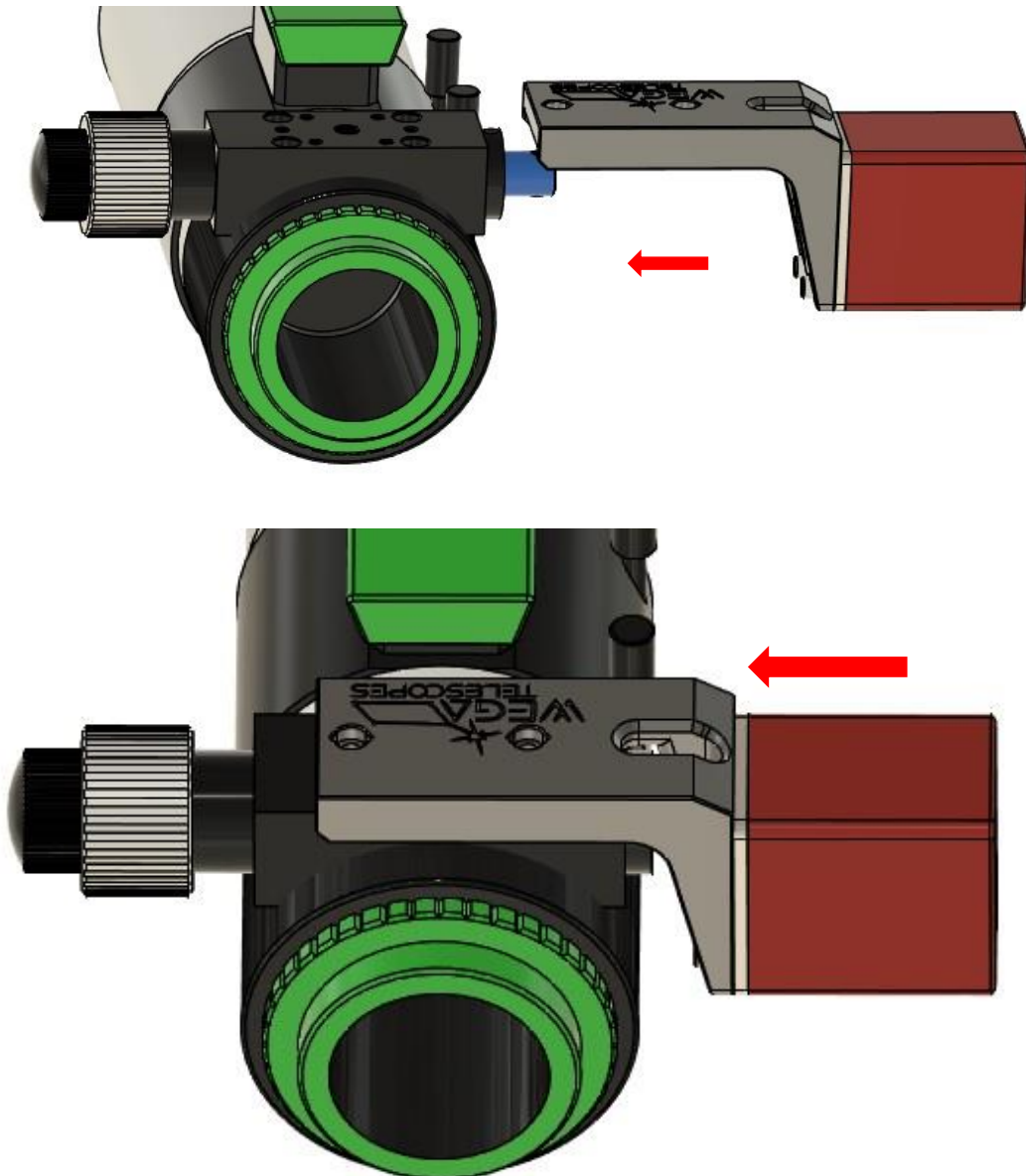

**Work step: 5**

Now screw the adapter to the focuser using the two enclosed M4x12 screws (3). You may have to push the adapter slightly to the left.

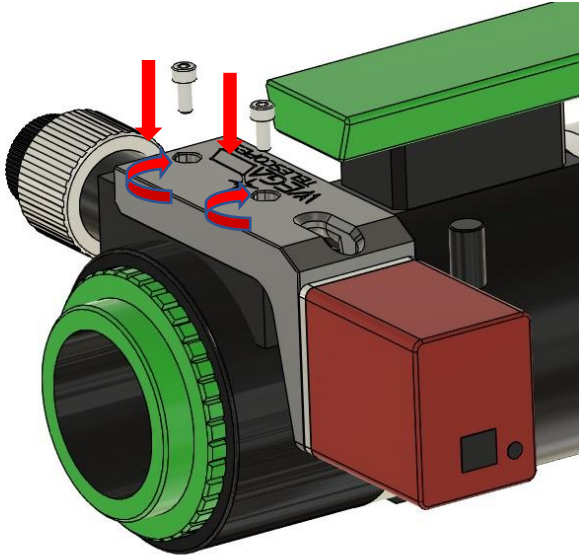
**Work step: 6**

Now screw the ZWO EAF to the shaft adapter (2). You may have to push the adapter slightly to the left.

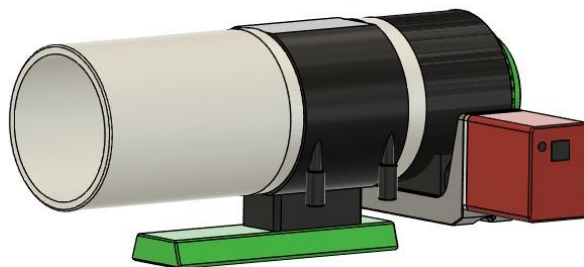
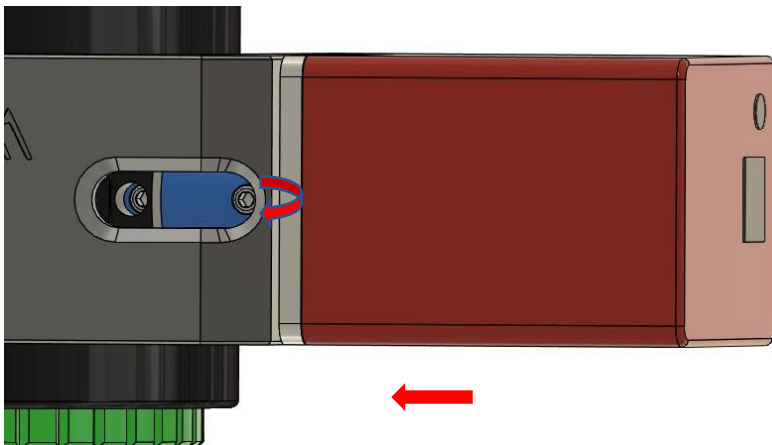

Congratulations! The installation is now complete.